

6550F18

18GHz 50Ω N Type Mechanical Calibration Kit

Overview

The 6550F18 calibration kits are used to calibrate network analyzers for measurements of components with N type connectors. This calibration kit is an alternative to Agilent 85054D. The Frequency Range is DC~18GHz.

Devices

Device	PN	Qty	Configuration
	6550F18		6550F18
Open(male)	6550F18KM	1	●
Open(female)	6550F18KF	1	●
Short(male)	6550F18DM	1	●
Short(female)	6550F18DF	1	●
Load(male)	6550F18LM	1	●
Load(female)	6550F18LF	1	●
Adapter(male to male)	6550A1801	1	○
Adapter(female to female)	6550A1802	1	○
Adapter(male to female)	6550A1803	1	○
Torque Wrench	B19T135	1	○
Box	HW01C1	1	●

●basic configuration ○options

Interface Dimensions

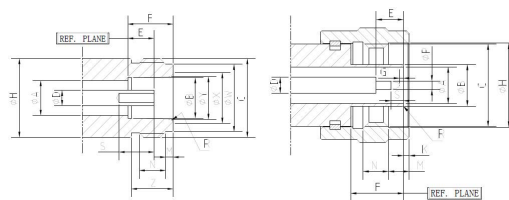

Ref.	Female			
	mm		Inch	
	Min.	Max.	Min.	Max.
A	6.99	7.01	0.2752	0.2760
B	8.05	8.1	0.317	0.319
C	5/8-24 UNEF-2A			
D	3.04		0.120	
E	5.18	5.26	0.204	0.207
F	9.07	9.17	0.357	0.361
H	-	15.93	-	0.627
M	1.19	1.96	0.047	0.077
N	4.37	—	0.172	—
R	-	1.2	-	0.047
S	7	-	0.276	-
W	-	-	-	-
X	-	-	-	-
Y	8.53	8.74	0.336	0.344
Z	6.76	-	0.266	-

Ref.	Male			
	mm		Inch	
	Min.	Max.	Min.	Max.
A	6.99	7.01	0.2752	0.2760
B	7.98	8.04	0.314	0.317
C	5/8-24 UNEF-2B			
D	3.04		0.120	
E	5.26	5.32	0.207	0.209
F	9.25	-	0.364	-
G	0.0	1.57	0.000	0.062
H	16	-	0.630	-
K	0.41	1.52	0.016	0.060
M	4.013	4.267	0.158	0.168
P	1.638	1.664	0.0645	0.0655
R	0.15	-	0.006	-
S	2.79	3.56	0.110	0.140

Electrical Specifications

- ◇ Impedance : 50Ω
- ◇ Average Power : ≤1W
- ◇ Electrical Specifications :

Device	6550F18	
	Frequency	Specifications
loads	DC~18GHz	Return Loss -32.6dB VSWR 1.048
opens	DC~18GHz	Deviation from Nominal Phase±1°
shorts	DC~18GHz	Deviation from Nominal Phase±1°
adapters	DC~18GHz (operating up to 18GHz) , Return loss: -30.7dB, VSWR: -1.06, Insertion loss: 0.2dB	

*The above specifications are relative to Agilent 85054D

Materials

Center conductor : beryllium bronze
 Body : stainless steel
 Connector nut : stainless steel

Standard

IEC 60169-16 Grade 0

Mechanical Characteristic

Connect/disconnect life : >500 times
 Maximum insertion force : 8.9N
 Coupling torque : 1.35 Nm
 Open-end wrench size : 19mm

Environmental Requirements

Parameter	Limits
Operating Temperature	+20°C~ +26°C (suggested)
Storage Temperature	-40°C~ +75°C

